

TIP SFH SFH TYPE

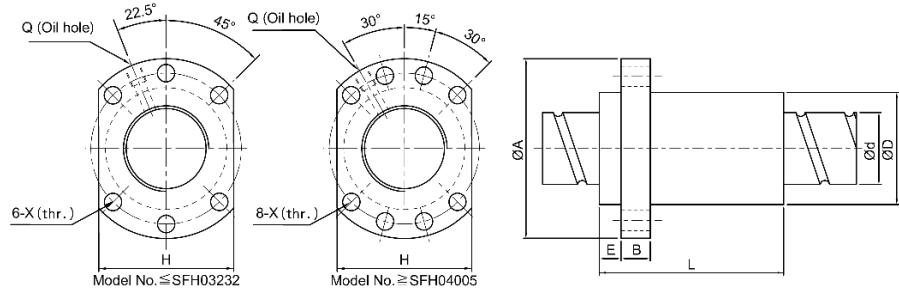

Cod / Code Dreapta / Right	Tip Type	d	l	Da	D	A	E	B	L	W	H	X	Q	n	Ca	Coa	K	
															(mm)			(N)
81.011.009	SFH01205-2.8	12	5	2.5	24	40	5	10	30	32	30	4.5	-	2.8x1	6610	13160	190	
81.011.010	SFH01210-2.8		10	2.5	24	40	5	10	45	32	30	4.5	-	2.8x1	6420	12870	190	
81.011.015	SFH01605-3.8	15	5	2.778	28	48	5	10	37	38	40	5.5	M6	3.8x1	11120	25070	300	
81.011.016	SFH01610-2.8		10	2.778	28	48	5	10	45	38	40	5.5	M6	2.8x1	8390	18210	230	
81.011.017	SFH01616-1.8		16	2.778	28	48	5	10	45	38	40	5.5	M6	1.8x1	5520	11370	140	
81.011.040	SFH01616-2.8		16	2.778	28	48	5	10	61	38	40	5.5	M6	2.8x1	8080	17690	220	
81.011.018	SFH01620-1.8		20	2.778	28	48	5	10	58	38	40	5.5	M6	1.8x1	5540	11700	140	
81.011.020	SFH02005-3.8		20	5	3.175	36	58	7	10	37	47	44	6.6	M6	3.8x1	14840	36810	370
81.011.023	SFH02010-3.8	10		3.175	36	58	7	10	55	47	44	6.6	M6	3.8x1	15160	38330	400	
81.011.024	SFH02020-1.8	20		3.175	36	58	7	10	54	47	44	6.6	M6	1.8x1	7640	17580	190	
81.011.049	SFH02020-2.8	20		3.175	36	58	7	10	74	47	44	6.6	M6	2.8x1	11180	27340	290	
81.011.026	SFH02505-3.8	25		5	3.175	40	62	7	10	37	51	48	6.6	M6	3.8x1	16500	46580	430
81.011.029	SFH02510-3.8			10	3.175	40	62	7	12	55	51	48	6.6	M6	3.8x1	16380	46330	450
81.011.030	SFH02525-1.8		25	3.175	40	62	7	12	64	51	48	6.6	M6	1.8x1	8430	21990	220	
81.011.055	SFH02525-2.8		25	3.175	40	62	7	12	89	51	48	6.6	M6	2.8x1	12320	34210	340	
81.011.032	SFH03205-3.8	32	5	3.175	50	80	9	12	37	65	62	9	M6	3.8x1	18390	60260	510	
81.011.035	SFH03210-3.8	31	10	3.969	50	80	9	12	57	65	62	9	M6	3.8x1	24600	72550	550	
81.011.036	SFH03220-2.8		20	3.969	50	80	9	12	76	65	62	9	M6	2.8x1	19070	54820	430	
81.011.037	SFH03232-1.8		32	3.969	50	80	9	12	80	65	62	9	M6	1.8x1	12570	34260	270	
81.011.056	SFH03232-2.8		32	3.969	50	80	9	12	112	65	62	9	M6	2.8x1	18380	53290	420	
81.011.038	SFH04005-3.8	40	5	3.175	63	93	9	15	42	78	70	9	M8	3.8x1	20180	75890	600	
81.011.041	SFH04010-3.8	38	10	6.35	63	93	9	14	60	78	70	9	M8	3.8x1	50350	139430	670	
81.011.042	SFH04020-2.8		20	6.35	63	93	9	14	80	78	70	9	M8	2.8x1	39590	107150	540	
81.011.043	SFH04040-1.8		40	6.35	63	93	9	14	98	78	70	9	M8	1.8x1	25850	66480	340	
81.011.057	SFH04040-2.8		40	6.35	63	93	9	14	138	78	70	9	M8	2.8x1	37800	103410	520	
81.011.044	SFH05005-3.8	50	5	3.175	75	110	10,5	15	42	93	85	11	M8	3.8x1	22070	95420	680	
81.011.045	SFH05010-3.8	48	10	6.35	75	110	10,5	18	60	93	85	11	M8	3.8x1	56380	178520	790	
81.011.047	SFH05020-3.8		20	6.35	75	110	10,5	18	100	93	85	11	M8	3.8x1	57490	184850	870	
81.011.048	SFH05050-1.8		50	6.35	75	110	10,5	18	120	93	85	11	M8	1.8x1	29460	87490	420	
81.011.058	SFH05050-2.8		50	6.35	75	110	10,5	18	170	93	85	11	M8	2.8x1	43080	13610	650	

▲ Explicația antetului a se vedea la pagina 70 / Explanation of letterhead see on page 70
Se poate utiliza cu șurub SSR! / It shall be used with SSR screw!