

AXE DE PRECIZIE ROTUNDE ROUND SHAFTS

TIP SF SF TYPE

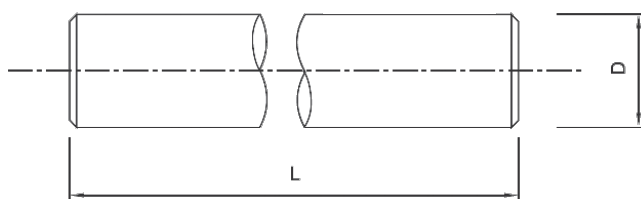
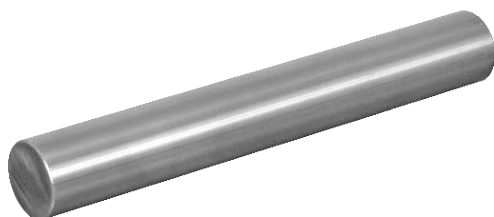

| Cod Code | Tip Type | D h6 | L Lungime max.* Max. length* | Adâncimea durității de suprafață | Concentricitatea | Paralelism | Greutate Weight |
|------------|----------|------|------------------------------------|----------------------------------|------------------|-------------|--------------------|
| | | | | Surface hardness depth | Roundness | Parallelism | |
| | | | | (mm) | (μm) | | (kg/m) |
| 84.001.001 | SF 4 | 4 | 6000 / 4000 | 0,5-0,8 | 3 | 4 | 0,1 |
| 84.001.002 | SF 6 | 6 | | 0,6-1,2 | 4 | 6 | 0,23 |
| 84.001.003 | SF 8 | 8 | | 0,6-1,2 | 4 | 6 | 0,4 |
| 84.001.004 | SF 10 | 10 | | 0,6-1,2 | 4 | 6 | 0,62 |
| 84.001.005 | SF 12 | 12 | | 0,6-1,3 | 5 | 8 | 0,89 |
| 84.001.006 | SF 14 | 14 | | 0,6-1,3 | 5 | 8 | 1,21 |
| 84.001.007 | SF 16 | 16 | | 0,6-1,3 | 5 | 8 | 1,58 |
| 84.001.008 | SF 18 | 18 | | 0,9-1,8 | 5 | 8 | 2 |
| 84.001.009 | SF 20 | 20 | | 0,9-1,8 | 6 | 8 | 2,47 |
| 84.001.010 | SF 22 | 22 | | 0,9-1,8 | 6 | 8 | 2,98 |
| 84.001.011 | SF 25 | 25 | | 0,9-1,8 | 6 | 9 | 3,85 |
| 84.001.012 | SF 28 | 28 | | 0,9-1,8 | 6 | 9 | 4,83 |
| 84.001.013 | SF 30 | 30 | | 0,9-1,8 | 6 | 9 | 5,55 |
| 84.001.014 | SF 35 | 35 | | 1,5-2,8 | 7 | 11 | 7,55 |
| 84.001.015 | SF 40 | 40 | | 1,5-2,8 | 7 | 11 | 9,87 |
| 84.001.016 | SF 50 | 50 | | 1,5-2,8 | 7 | 11 | 15,4 |
| 84.001.017 | SF 60 | 60 | | 2,2-3,9 | 8 | 13 | 18,64 |
| 84.001.018 | SF 70 | 70 | | 2,2-3,9 | 8 | 13 | 22,2 |
| 84.001.019 | SF 80 | 80 | | 2,2-3,9 | 8 | 13 | 30,2 |
| 84.001.020 | SF 90 | 90 | | 2,8-4,5 | 8 | 13 | 49,92 |
| 84.001.021 | SF 100 | 100 | | 2,8-4,5 | 8 | 13 | 61,62 |

* - Pentru lungimile maxime disponibile, vă rog să întrebați persoana de contact

* - The exact maximum length to inquire about your contact person

Material ax: CF53

Shaft material: CF53

Duritatea suprafeței tratate: 62-64 HRC

Hardened surface hardness: 62-64 HRC