

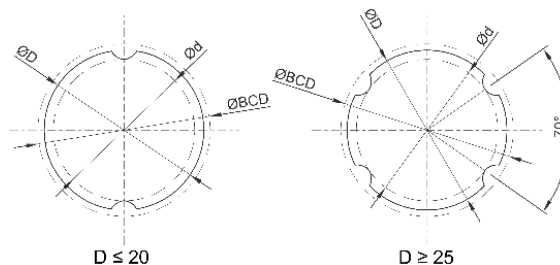

TIP SC-S  
 SC-S TYPE



Cod Codes	Tip Codes	Cod Codes	Tip Codes	D h7	d	BCD	Toleranță Tolerance	Greutate Weight
N		H		(mm)			( $\mu\text{m}$ )	(kg/m)
84.079.002	SC006T2NS	84.080.002	SC006T2HS	6	5,25	6,75	0	0,22
84.079.003	SC008T2NS	84.080.003	SC008T2HS	8	7,27	8,77	-15	0,39
84.079.004	SC010T2NS	84.080.004	SC010T2HS	10	8,97	11,35	0	0,6
84.079.022	SC013T2NS	84.080.022	SC013T2HS	13	11,82	14,6		-18
84.079.007	SC016T2NS	84.080.007	SC016T2HS	16	14,72	17,5	0	1,56
84.079.009	SC020T2NS	84.080.009	SC020T2HS	20	18,63	21,8		-21
84.079.011	SC025T4NS	84.080.011	SC025T4HS	25	23,43	27	0	3,8
84.079.013	SC030T4NS	84.080.013	SC030T4HS	30	28,53	32,1		-25
84.079.015	SC040T4NS	84.080.015	SC040T4HS	40	37,3	43,65	0 / -30	9,69
84.079.016	SC050T4NS	84.080.016	SC050T4HS	50	47,05	54,2		-30

**N:** precizie normală standard accuracy  
**H:** precizie înaltă high accuracy