

# Guides for Round Belts

## TYPE RR

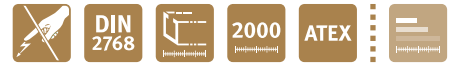

Belt type / Ø	B	H	h	r	Article no.
5.0	20	10	3	3	231 010 027
6.3	20	10	4	4	231 010 028
8.0	20	12	5	5	231 010 029
9.5	25	15	6	6	231 010 030
12.5	28	20	8	7	231 010 031
15.0	33	25	10	9	231 010 032
18.0	38	25	12	10	231 010 033

Dimensions in mm

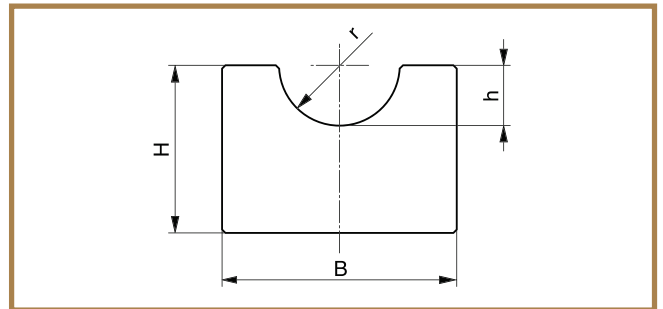
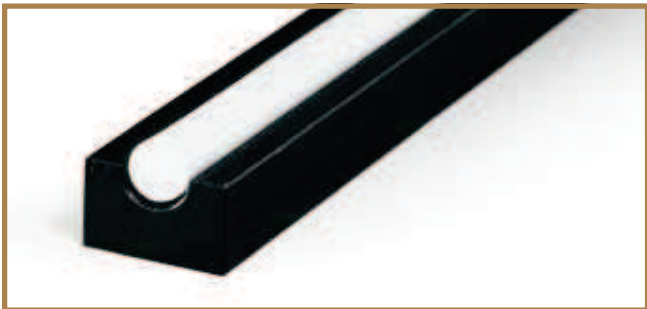

## TYPE RRC



Belt type / Ø	C profile type	B <sub>1</sub>	B <sub>2</sub>	H	H <sub>c</sub>	h	r	Article no.
5.0		20		10	15	3	3	231 110 035
	C3		20					351 020 003
6.3		20		15	18	4	4	231 110 036
	C3		20					351 020 003
8.0		20		15	18	5	5	231 110 037
	C3		20					351 020 003
9.5		25		15	20	6	6	231 110 038
	C5		28					351 020 005
12.5		28		15	20	8	7	231 110 039
	C5		28					351 020 005
15.0		33		20	25	10	9	231 110 040
	C9		38					351 020 009
18.0		38		20	25	12	10	231 110 041
	C9		38					351 020 009

Dimensions in mm

