

TIP FTSN-GW
 FTSN-GW TYPE

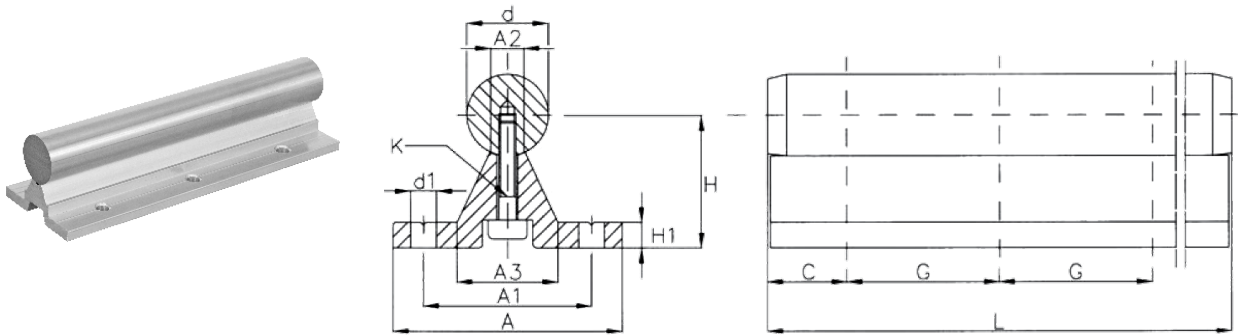

Cod Code	Tip Type	Ø Ax Shaft Ø	(mm)											Greutate Weight (kg/m)
			A	H	A1	A2	A3	H1	d1	K	C	G	L max	
84.077.005	FTSN-GW12	12	40	22	29	5,4	15	5	4,5	M4x20	La cerere To defined	75	6000	1,67
84.077.007	FTSN-GW16	16	45	26	33	7	19	5	5,5	M5x20		100	6000	2,95
84.077.009	FTSN-GW20	20	52	32	37	8,1	23	6	6,6	M6x26		100	6000	3,95
84.077.011	FTSN-GW25	25	57	36	42	10,3	26	6	6,6	M8x30		120	6000	5,6
84.077.013	FTSN-GW30	30	69	42	51	11	29	7	9	M10x30		150	6000	7,88
84.077.015	FTSN-GW40	40	73	50	55	15	36	8	9	M10x40		200	6000	12,83
84.077.016	FTSN-GW50	50	84	60	63	19	40	9	11	M12x45		200	6000	19,38

Acest produs este compatibil cu elementele INA-TSNW; SKF-LRCB.
 This product is the INA-TSNW; SKF-LRCB items compatible.