

C197

C193-C194-C195-BASE



Material:

Reinforced and stabilised polyamide.
Oils and greases resistant.

Surface:

Satin.

Colour:

Black (RAL 9011).

Central Cap:

Grey polyamide (RAL 7035 cod. 13).

Alternative Cap Colour:

- Orange (RAL 2004 cod. 02)
- Blue (RAL 5015 cod. 07)
- Yellow (RAL 1021 cod. 10)
- Red (RAL 3000 cod. 16)
- Green (RAL 6024 cod. 17)
- Black (RAL 9011 cod. 01)

Main Insert:

Zinc plated steel insert with smooth through-hole (H10 tolerance).

Side Insert:

Brass right through threaded bush.

Side handle:

Revolving handle M144 (pag. M-08).

For fixing system, or execution of keyway or square holes, please refer to the technical notes attached to the catalogue.

SPECIAL REQUEST:

- It's possible to supply the inserts with d1 bore by customer design, on request and for quantities.
- It's possible to supply the inserts in different material and treatment-finishes, on request and for quantities.
- It's possible to supply the products with colours (reduced range) as shown in the table at page C-11, on request and for quantities.

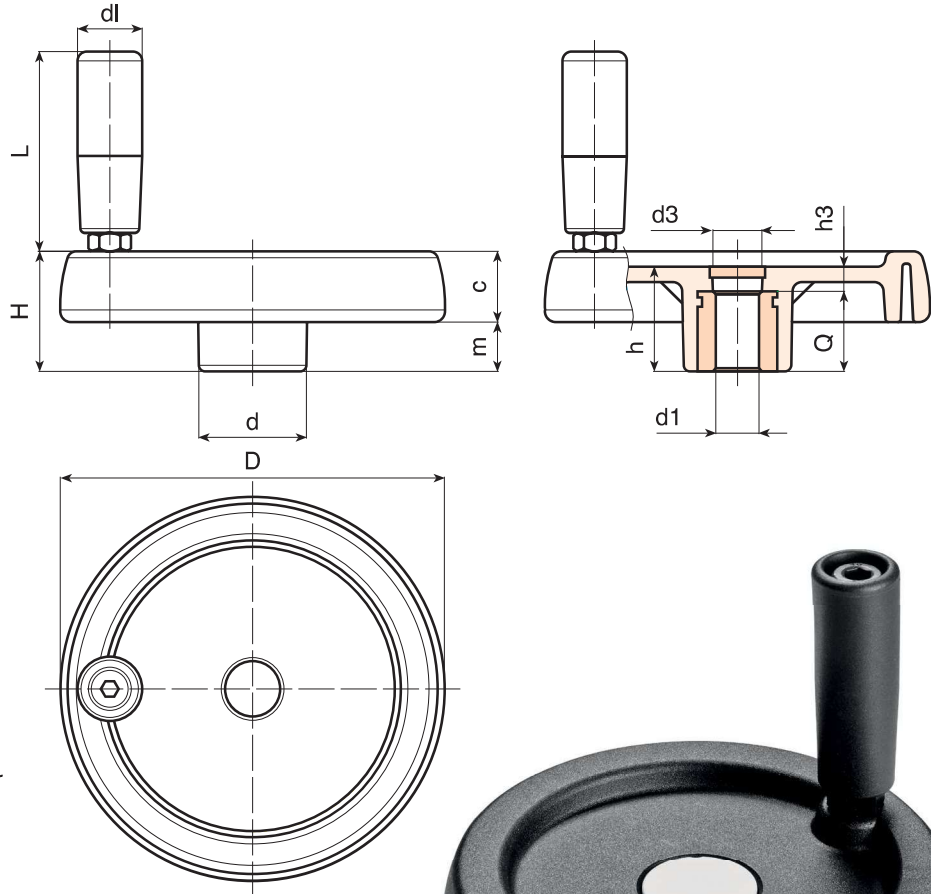

Version with zinc plated insert and H10 tolerance bore

Art.	D	H	h	d	m	c	d3	h3	dl	L	Dm	d1 H10	Q	g
● C197080.TP0501P	81	33	29	25	16	17	16	9	20	56	12	05	20	130
● C197100.TP0501P	100	39	34	30	18,5	20,5	16	10	20	56	16	05	24	192
● C197125.TP0501P	125	44	37	36	20	24	26	13	21	65	18	05	24	351
● C197150.TD0801P	150	54	44	38	25	29	26	12	23	76	22	08	32	588
● C197175.TD0801P	173	57	47	40	25,5	31,5	26	15	25	86	22	08	32	770
● C197200.TD0801P	202	59	49	44	24	35	27	13	25	86	28	08	36	980
● C197250.TD0801P	249	68	58	59	29	39	36	22	25	86	28	08	36	1530

Attention: bore d1 (H10 tolerance) could be produced by request, with 50 pieces minimum.

Dm = It's possible to increase the hole, by boring, until Dm (enlarge).

Version with black-oxide insert and H7 tolerance bore

Art.	D	H	h	d	m	c	d3	h3	dl	L	Dm	d1 H7	Q	g
● C197080.TD..01PZB	81	33	29	25	16	17	16	9	20	56	12	A.R.	20	130
● C197100.TD..01PZB	100	39	34	30	18,5	20,5	16	10	20	56	16	A.R.	24	192
● C197125.TD..01PZB	125	44	37	36	20	24	26	13	21	65	18	A.R.	24	351
● C197150.TD..01PZB	150	54	44	38	25	29	26	12	23	76	22	A.R.	32	588
● C197175.TD..01PZB	173	57	47	40	25,5	31,5	26	15	25	86	22	A.R.	32	770
● C197200.TD..01PZB	202	59	49	44	24	35	27	13	25	86	28	A.R.	36	980
● C197250.TD..01PZB	249	68	58	59	29	39	36	22	25	86	28	A.R.	36	1530

Attention: replace the two places in the code .. with the hole diameter required - 50 pieces minimum.

Dm = It's possible to increase the hole, by boring, until Dm (enlarge). **A.R.** = By request

